



CAHP3.0

Air to Water Heat Pump

Storage Capacity - 450 liters
Output Power - 12kW

The CAHP heat pump water heater is an integrated system that utilizes the heat pump technology to provide more efficient way to heat water with electricity. CAHP pulls heat from surrounding air and deposits the heat into the tank. The result is very efficient production of hot water with cooler and dehumidified air as a welcome by-product.

Suitable for villas and light commercial applications

FEATURES

- Absorbs Environment heat and transfers it to the water, at the same time cooling and dehumidifying the ambient air.
- “Environmental-friendly” R-134a refrigerant.
- Dual operating modes maximize efficiency & meet increasing hot water needs.
- High-capacity storage tank enables heat pump to operate more frequently than the heating elements. This provides higher efficiency & cover operating costs, saving money for the homeowner.
- Triple protection - Humidity sensor, built-in Anti-dry & Anti-frost function.
- Water can be heated up to 65°C with heat pump mode, which prevents breeding of Legionella bacteria.
- Large LCD touch pad display which communicates status and displays error messages in plain English when applicable.
- Intuitive icons clearly indicate the current operating mode.
- Internal & external two stage coil condenser. The external coil preheats the cold water at the bottom of the tank, thereby improving the energy efficiency of the unit.



SPECIFICATIONS

Model		CAHP 120C 12	
Heat Pump Nominal Input Power	KW	2.5	
Heat Pump Nominal Heating Capacity	KW	8.5	
Element Power	KW	12	
Maximum input power	KW	15.1	
Maximum Heating Capacity	KW	20	
Maximum Operation Current	380V/3N/50Hz	A	31.5
	220V/1N/50Hz	A	78.5
Maximum Water Temperature of Heat Pump Operation	°C	65	
Water Temperature Setting Range	°C	35~82	
Tank Volume	L	430	
Net / Operation Weight	kg	694	
Hot Water Delivery Rate	Efficiency/ Standard Mode	L/h	182
	High Demand / Winter Mode	L/h	439
Refrigerant Charge Quantity	g	R134a / 2250	
Heat Pump Operation Ambient Temperature Range	°C	0~48	
Unit operation Ambient Temperature Range	°C	-10~50	
Sound Level (Sound Pressure @ 1m)	dB	59	

OPERATING MODES

- **Efficiency:** Energy conservation mode, Extracts heat from the surrounding air, concentrating the heat and transferring it to the water.
- **Hybrid:** This mode uses the heat pump for efficiency but will use the electrical element for quick recovery following increased hot water usage.

DIMENSIONS:

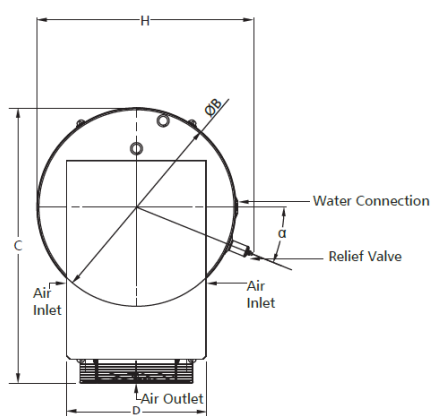
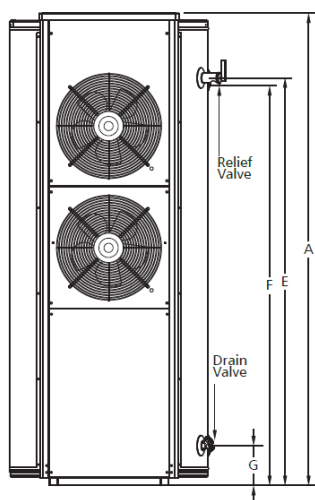

Model	A	B	C	D	E	F	G	α (°)	H
CAHP-120C	1770mm	711mm	1002mm	600mm	1476mm	1468mm	153mm	22	770mm